

PLAN OF NORTH MELBOURNE.

DIVISION INTO
ALLOTMENTS,

of the Original Purchasers

SOLD LANDS,

with a list of Public Buildings & other

useful topographical information

compiled & arranged from the most

authentic sources.

by
Charles Laing.

Architect & Surveyor.

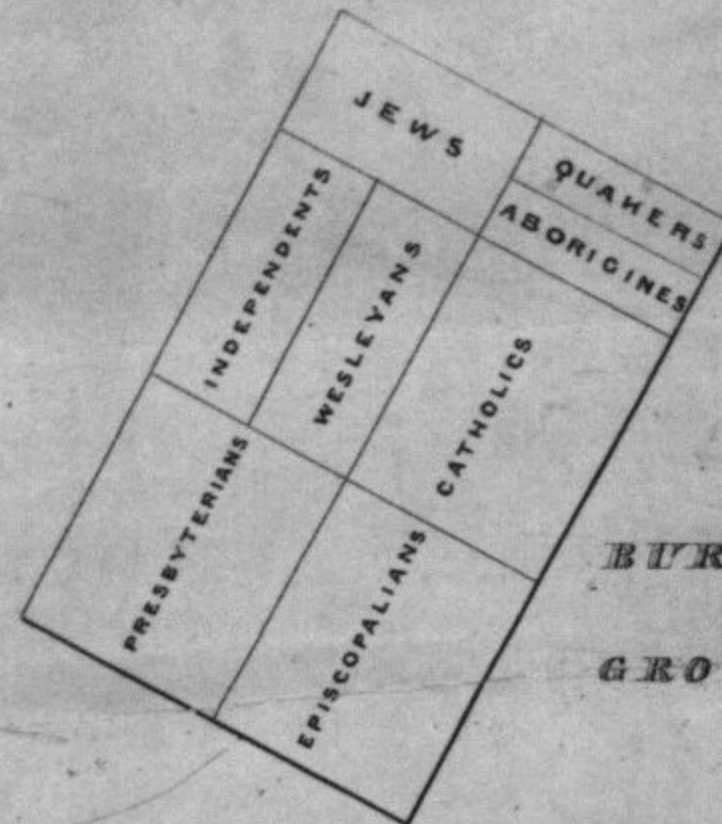

BURIAL
GROUND



SCALE OF CHAINS

N 62° E

N 28° W

S 28° E

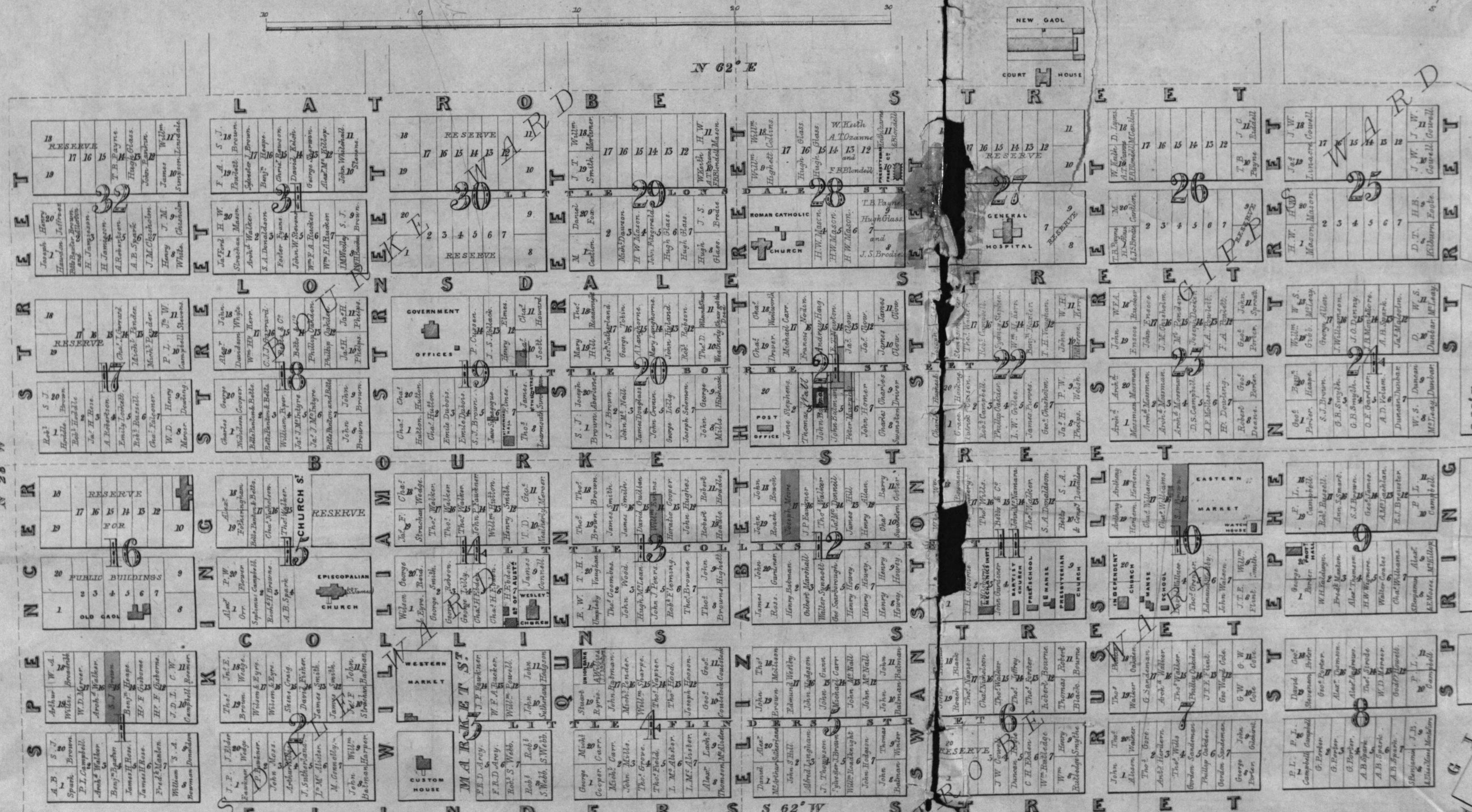

8th 1841

Balman Hill