

16

Survey

of

Allotments in the Parish of

BOROONDARA

COUNTY OF BURKE

as recently marked by R. Hoddle, Surveyor.

April 1844.

Scale of Chains.

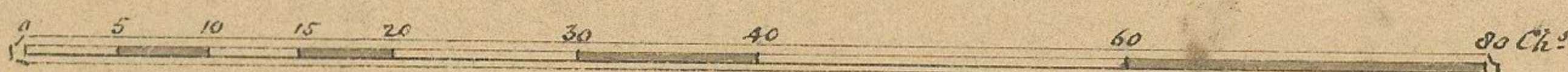

REFERENCE

| Allotment | Corner | Tree or Stake | Bearing | N of links | To or from | Marked | Remarks | Nature & Value of the land |
|-------------------|--------|----------------------------|---------|------------|-----------------------|----------|------------------------|--|
| N ^o 52 | N.E. | large W Gum | | | | | close to River | Rich soil in flat, middling where fenced in, very poor at the back. |
| | S.E. | Stake | 296° | 132 | to Gum | I | | |
| | S.W. | large Gum | 355° | 102 | 5 ^m stake | | | scrubby along river, 30 th p. acre. |
| | N.W. | Stake | 204° | 50 | to Myrtle | I & II | | |
| N ^o 53 | W. | do. | 342° | 35 | to Impenitent | III | | Rich soil in flat, middling at the back, 35 th p. acre. |
| | N.W. | Gum | South | 120 | from Stake | III & IV | | |
| N ^o 54 | N.W. | Stake | 144° | 21 | to Gum | | | Rich soil in flat, middling at the back, 30 th p. acre. |
| | S.W. | Wattle Stake | | | | | | |
| N ^o 55 | N.E. | Swainson Gum | South | 150 | 5 ^m Stake | IV | close to River | Good soil, 40 th p. acre. |
| | S.E. | Stake | 312° | 80 | Gum | IV | | |
| N ^o 56 | N.E. | do. | | 78 | do | V | | Rich soil in flat, middling above the road, 30 th p. acre. |
| | N.W. | do. | South | 40 | do | V | | |
| | S.W. | do. | 76° | 100 | Gum | V | | |
| N ^o 57 | N.E. | corner of N ^o 5 | 230° | 121 | to Gum | VI | | Good soil in flat, the same in dec. is light gum, 25 th p. acre. |
| | S.E. | Oak | North | 46 | | VI | | |
| | S.W. | Stake | 163° | 40 | large Gum | VI & VII | | |
| | N.W. | do | East | 20 | to Oak | VI | | |
| N ^o 58 | N.W. | Oak | West | 20 | 5 ^m stake | VII | | Middling soil, more fenced in, light soil at the back, 20 th p. acre. |
| | S.E. | large Gum | 163° | 45 | do | VIII | | |
| N ^o 59 | N.E. | Stake | W 05° E | 20 | to Gum | VIII | both on edge of River | Middling soil, more cultivated, light gum at the back, 20 th p. acre. |
| | do | do | East | 18 | to do | VII | | |
| | N.W. | Gum | | | | 4 | close to old fence | |
| | S.W. | Stake | 320° | 30 | to old market | 4 & 5 | | |
| N ^o 60 | N.E. | do | 296° | 17 | to fork of Gum | IX & X | | With the exception of the small flat the soil is poor & thickly timbered. |
| | S.E. | Stake | 37° | 35 | lean ^d Box | X | | |
| | S.W. | Wattle | near | | large Gum | X | on bank of River | 20 th p. acre. |
| | N.W. | large Gum | | | | IX & X | | |
| N ^o 61 | N.E. | Stake | 320° | 30 | to old market | IX & X | | With the exception of the small flat the River the land is poor, and heavily timbered, 20 th p. acre. |
| | N.W. | Gum | | | | IX & X | on steep bank of River | |

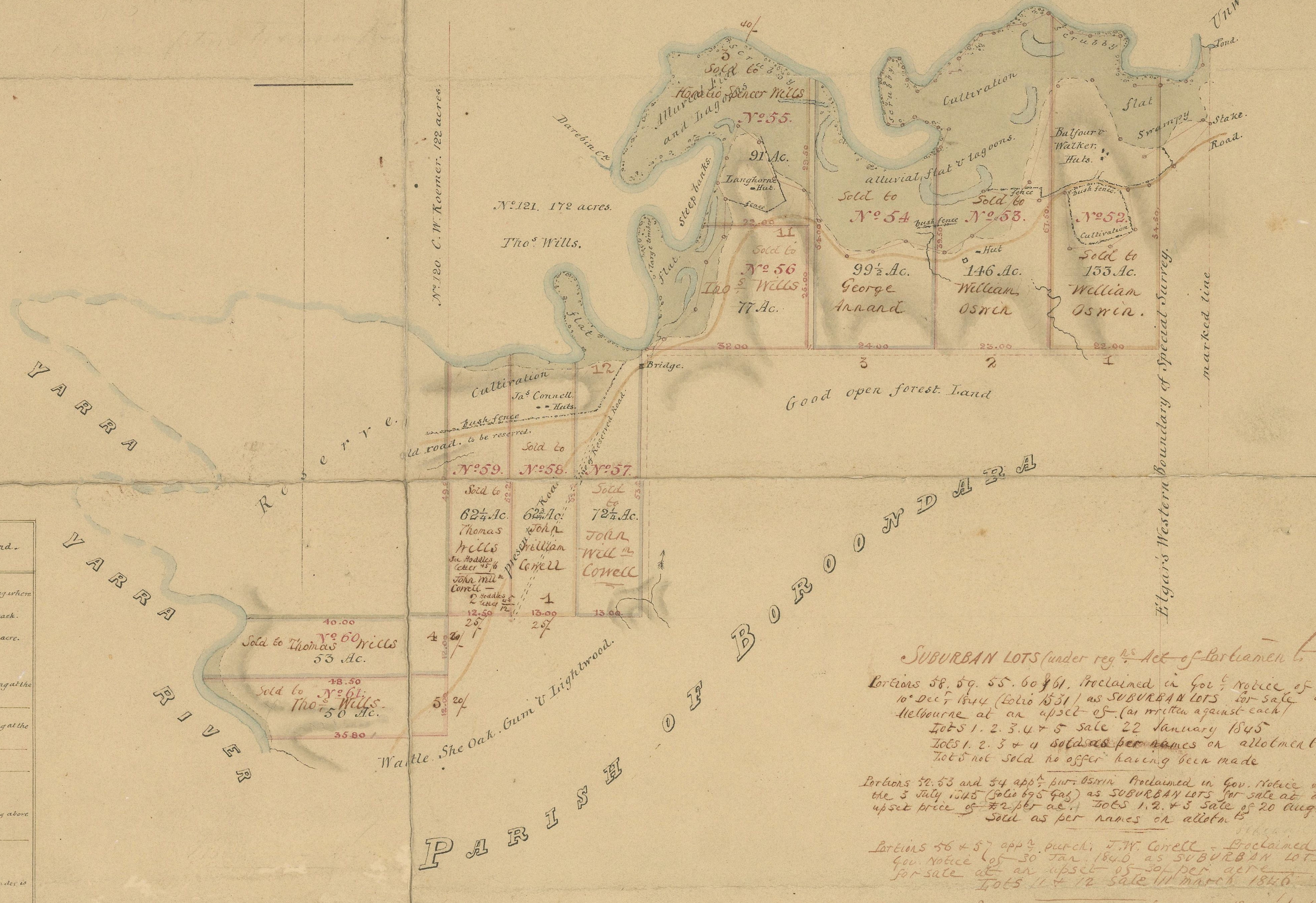

SUBURBAN LOTS (under reg^d Act of Parliament)

Portions 58, 59, 55, 60 & 61, proclaimed in Gov^t notice of the 10th Dec^r 1844 (folio 1531) as SUBURBAN LOTS for sale at Melbourne at an upset of 5/- (as written against each) Lots 1, 2, 3, 4 & 5 sale 22 January 1845. Lots 1, 2, 3 & 4 sold as per names on allotments - Lot 5 not sold no offer having been made.

Portions 52, 53 and 54 app^d purch^d by W. Cornell - proclaimed in Gov^t notice of the 3rd July 1845 (folio 695) as SUBURBAN LOTS for sale at an upset price of 7/2 per acre. Lots 1, 2, & 3 sale 20 Augst 1845. Sold as per names on allotments.

Portions 56 & 57 app^d purch^d by W. Cornell - proclaimed in Gov^t notice of 30 Jan^y 1840 as SUBURBAN LOTS for sale at an upset of 5/- per acre. Lots 11 & 12 sale 11 March 1840.

Portion 61 proclaimed in Gov^t notice of 23 Oct^r 1847 (folio 1177) for sale at an upset of 3/- per acre - Lot 10 sale 8 Dec^r 1847 - sold to Thomas Wells.

Transmitted with Descriptions and my Letter N^o 44/31
Dated 13th April 1844.

Robert Hoddle
Surveyor

Retransmitted with Descriptions and my Letter N^o 44/42
Dated 8th June 1844.

Robert Hoddle
Surveyor

B
19 Sydney

6207