

L. 679

PROCLAMATION No 18/60.

Country Lots
ON THE AXE CREEK

PARISH OF SEDGWICK

COUNTY UNNAMED

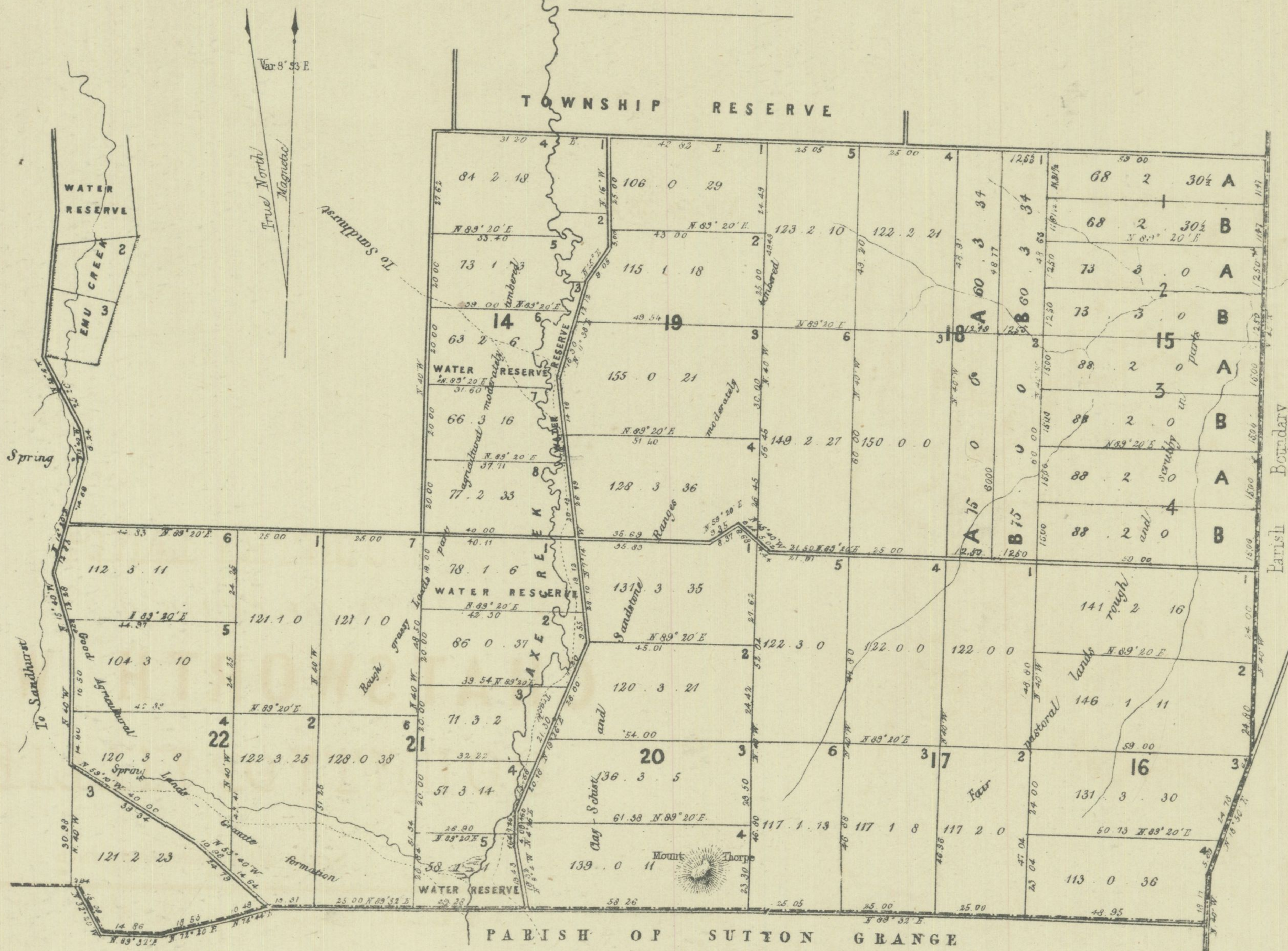

Scale 40 Chains to 1 Inch.

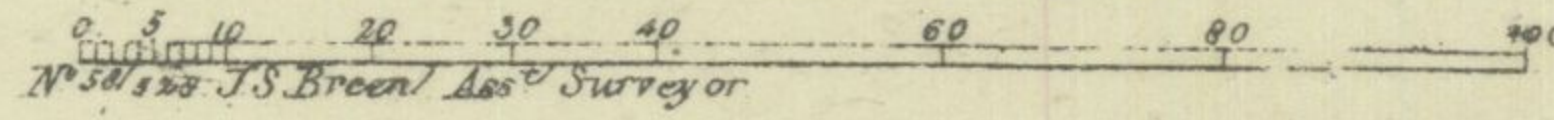

Crown Lands Office/ Melbourne, Nov. 2nd 1860

Price 1/-

To be purchased at the Department of Lands & Survey, Melbourne,
and at the District Survey Office at Sandhurst

Photo-lithographed by J.W. Osborne, at the Department of Lands & Survey, Melbourne.

SALE PLAN 501